



# AquaBead/AlphaONE LH Instructions



## Congratulations

### on your new AquaBead/AlphaONE LH Filter

You have made a wise choice in choosing the AlphaONE LH filter. Your filter was carefully thought out and designed to give you many years of faithful, worry free service. Some of the care and planning of your filter is self evident in even the small things, such as the Lifetime Warranty on the tank itself. The tanks are made of the ultimate filter vessel material, fiberglass. This is a higher quality tank than the typical plastic tank used on many filters.

Your clear spring check valve for the AlphaONE bead Agitator is designed so in time (normally many, many years) when the check valve goes out you can simply unscrew the union and replace just the valve seat itself in just a few minutes.

Your Multiport valve was carefully chosen to be the least restrictive backwash valve on the market to give maximum flows for the least energy dollars. The internals were carefully designed with maximum flows in mind to give further energy savings, by allowing you to use the most energy efficient pumps on the market.

The AlphaONE Life Support System allows you to hook up a koi pond air pump to the supplied fitting on the front of the multiport valve and supply life giving oxygen to the filter bacteria during times of medical bypass or pump failure.

The AlphaONE Bead Agitator is a high quality air blower that injects huge amounts of air into the vessel prior to backwash, this breaks up the bead pack which allows for a very thorough backwash.

**Rest assured that quality was the main consideration when your AlphaONE filter was designed and assembled.**



## Getting to know your AB/AO LH filter

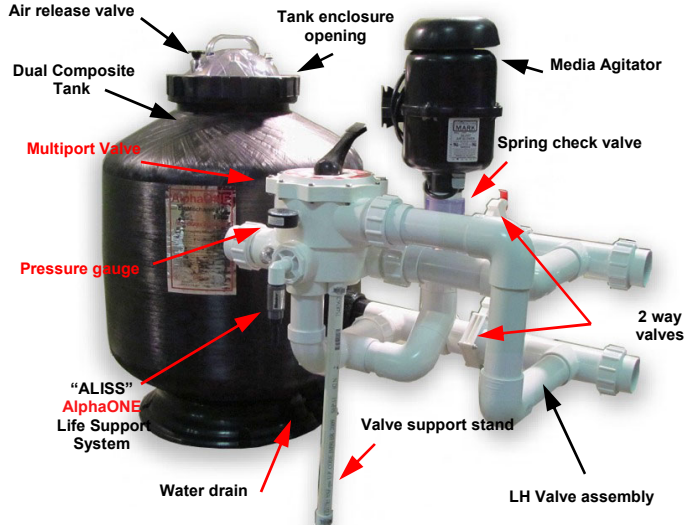

## Assembly of your AB/AO LH

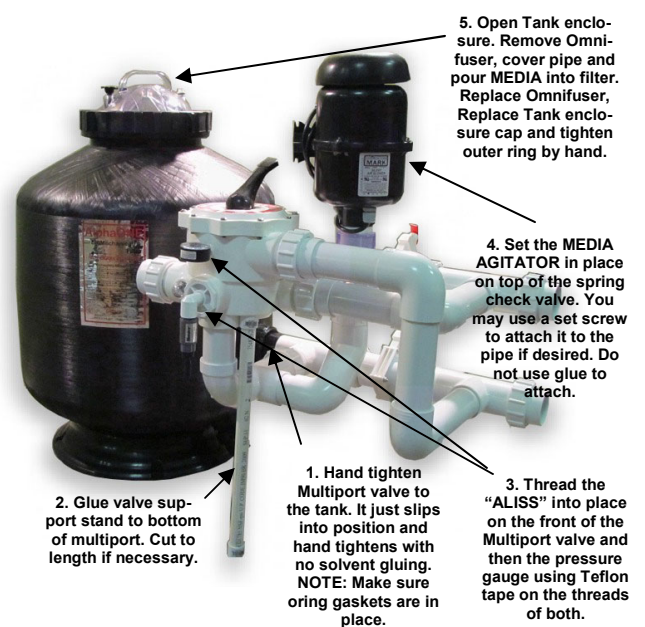

If you have any questions on your filter feel free to give us a call and we'll be glad to help.

## AB/AO LH Plumbing hook up assembly

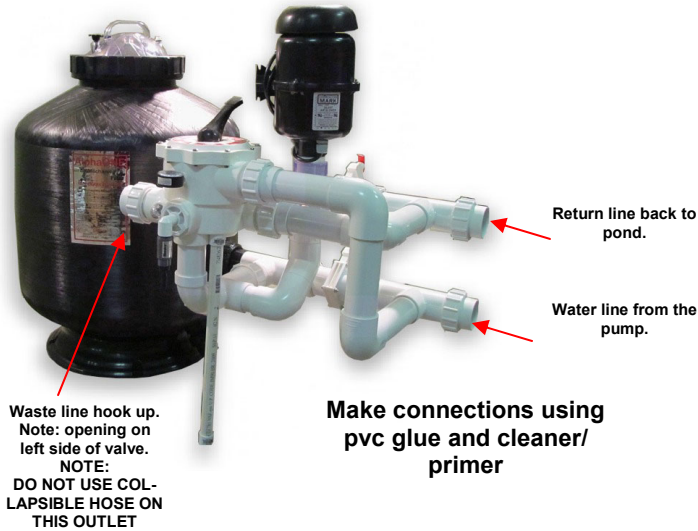

## AB/AO LH Life Support System

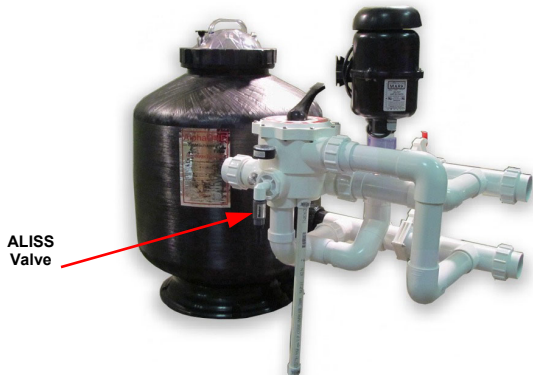

Your AlphaONE filter addresses the age old problem of "how do I keep my beneficial bacteria from dying when I have to do a medical bypass or I experience pump failure?"

Easy and simple. Just run a line from your koi pond air pump and attach it to the barbed fitting on the front of the multiport valve. Set the Multiport valve to the "RINSE" setting prior to turning on the air pump. Turn on the air pump and the oxygen supplied by the air pump will keep the bacteria happy and safe for several days if necessary. Remember, never run the water pump at the same time that you are running your air pump. It will cause damage to the air pump.

### Winterizing the AB/AO FILTER

1. Turn pump off and drain water from pump basket and volute.
2. Open water drain on filter. No media will come out, only water.
3. Loosen the Multiport valve from the housing and back the valve away from the tank to release any water in the valve.
4. Now just wait for Spring.



## Backwashing the AB/AO LH filter

**BACK WASH YOUR FILTER WEEKLY  
DO NOT USE PRESSURE GAUGE READINGS TO  
DETERMINE WHEN THE FILTER NEEDS  
BACKWASHING**

1. Turn off water pump. Close both 2 way valves by turning pointer to point at valve opening. Move Multiport valve to "RINSE". Turn on Agitator. Run and cycle Agitator with 20 second on and 5 second off cycles for 5 or 6 cycles. Turn off Agitator.
2. While still in the "RINSE" mode, turn water pump on and run until water starts to go out the waste line and then stop water pump.
3. Move Multiport valve to "BACKWASH" position, start water pump and run until water is clear in sight glass. Usually 1-3 minutes. Stop pump.
4. Move Multiport valve to the "RINSE" position, restart pump and run until water is clear in sight glass. Stop water pump.
5. Move Multiport valve to the "FILTER" position, turn both 2 way valves to open position which is with the pointer pointing not in line with the pipe and restart the water pump. You're done, it's that simple.

*Your AB/AO filter was designed to get rid of the solids when backwashed thus providing you with a more efficient filter and fewer backwashings being needed.*

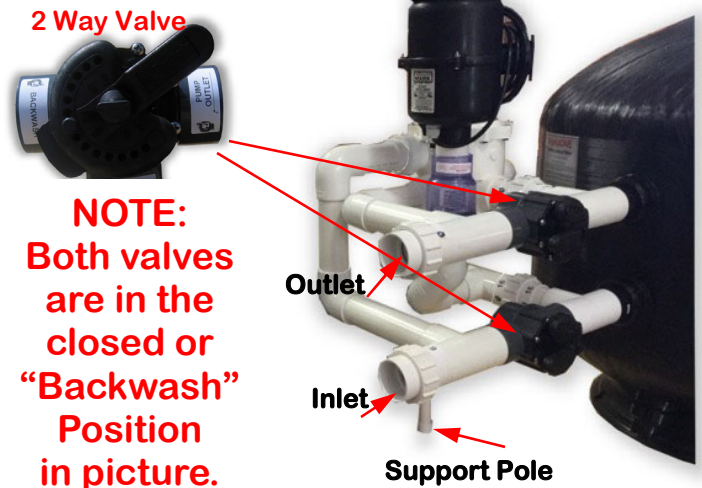

Other positions on the Multiport valves:  
Recirculate- Recirculate bypasses the inside the filter and sends water back to the pond. Useful for medical bypasses of the filter, etc.  
Waste- Waste setting bypasses the inside of the filter and sends water out the waste line. Useful for vacuuming the pond, draining the pond, etc.

**405-258-5551  
FAX 866-728-0678  
INFO@GCTEK.COM**